

DO NOT SCALE. IF IN DOUBT ASK!

FB180 50mm: 60/30  
FB180 60mm: 90/60

THIS DETAIL IS PART OF THE ABLATIVE WALL SYSTEM  
SEE: (B-001) FOR MORE INFORMATION

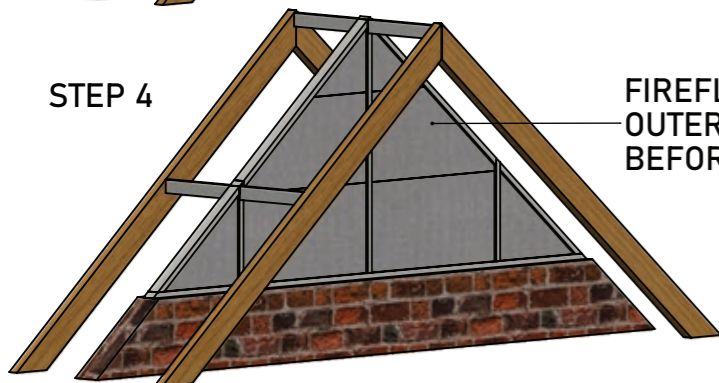
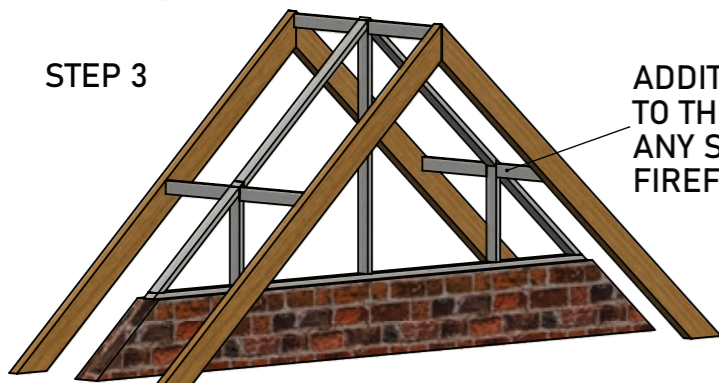
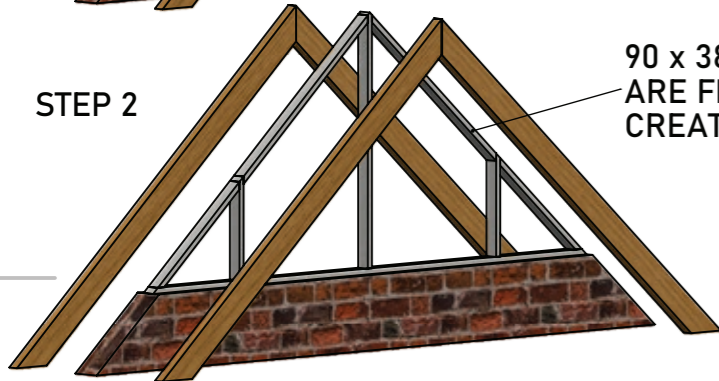
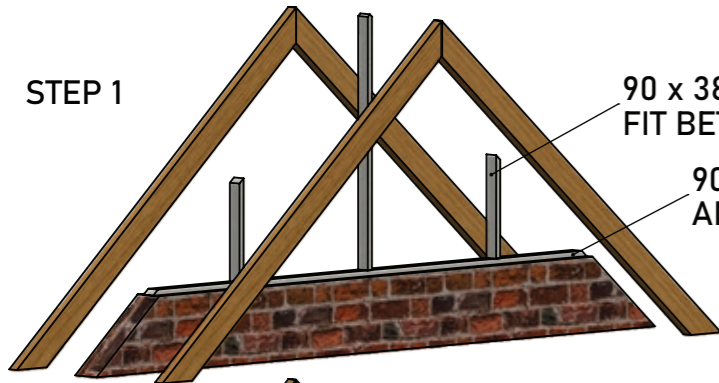
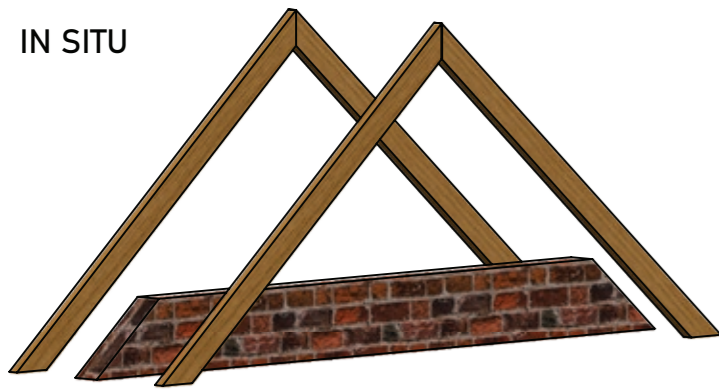

90 x 38mm (MINIMUM THICKNESS) VERTICAL TIMBER PAINTED WITH FIREFLY® ABLATIVE COATING  
FIT BETWEEN THE BASE TIMBER AND ROOF, FIT AT 1200mm (MAX) CENTRES

90 x 38mm TIMBER PAINTED WITH FIREFLY® ABLATIVE COATING  
AND SECURED TO THE FLOOR/BASE OF THE ASSEMBLY

90 x 38mm TIMBER PAINTED WITH FIREFLY® ABLATIVE COATING  
ARE FIT FLUSH TO THE ROOF BETWEEN THE VERTICAL TIMBERS,  
CREATING A FRAME FOR THE ASSEMBLY

ADDITIONAL TIMBER IS FIT FROM THE IN SITU TRUSSES  
TO THE VERTICAL ABLATIVE TIMBERS  
ANY SUPPORTING TIMBERS MUST BE PAINTED WITH  
FIREFLY® ABLATIVE COATING

FIREFLY® FB180 ABLATIVE BATT  
OUTER EDGES TO BE BUTTERED WITH FIREFLY® ABLATIVE COATING  
BEFORE BEING FRICTION FITTED BETWEEN THE ABLATIVE TIMBERS

ALL JOINTS TO BE FINISHED WITH A 6mm BEAD OF FIREFLY®  
INTUMESCENT ACRYLIC, FLATTENED OVER THE JOINT

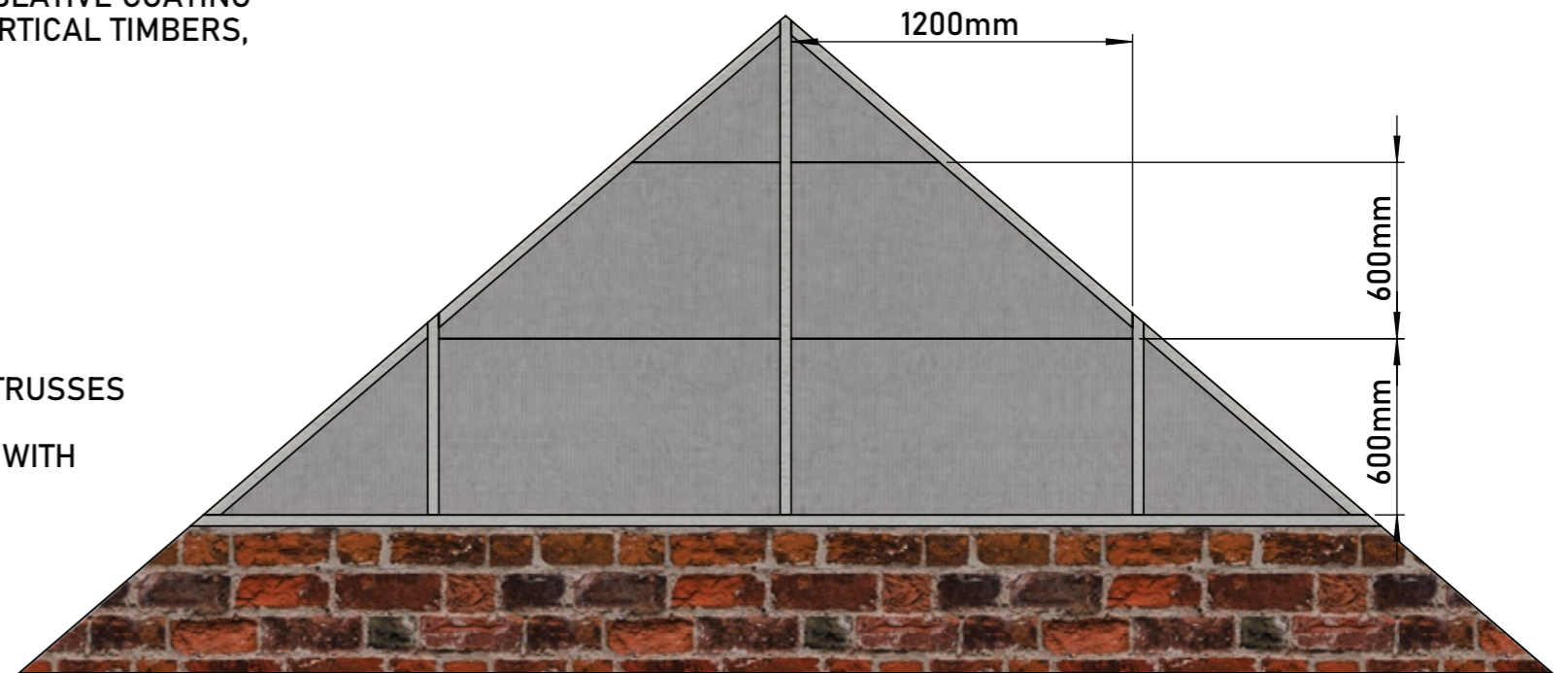

**FB180 ABLATIVE BATT - BATT WALL INBETWEEN TRUSSES**

TBA PROTECTIVE  
TECHNOLOGIES LTD  
Unit 3, Transpennine Trading Estate,  
Gorrells Way Rochdale, OL11 2PX,  
United Kingdom  
T: +44 (0)1706 758 817  
E: Technical@TBAFIREFLY.COM  
W: WWW.TBAFIREFLY.COM

DESIGNER: JC

APPROVED: KG

DATE: 11/03/2024

SCALE: NTS

DRAWING NO:

**B - 004**

REVISION: 4

IN SEQUENCE: 1/1

All rights reserved. No parts of this drawing may be used reproduced, altered, stored in a retrieval system or transmitted in any form or by any means without the prior written permission of tba protective technologies ltd. Whilst every effort has been made to comply with the current statutory regulations, it is the user's responsibility to ensure that the final detailing and installation meets the requirements of relevant regulatory authority (often building control). Please check www.tbafirefly.com to ensure that you are using the correct and current version. Copyright © 2023

